

Automatic welding and CNC cleaning line

AUSTER

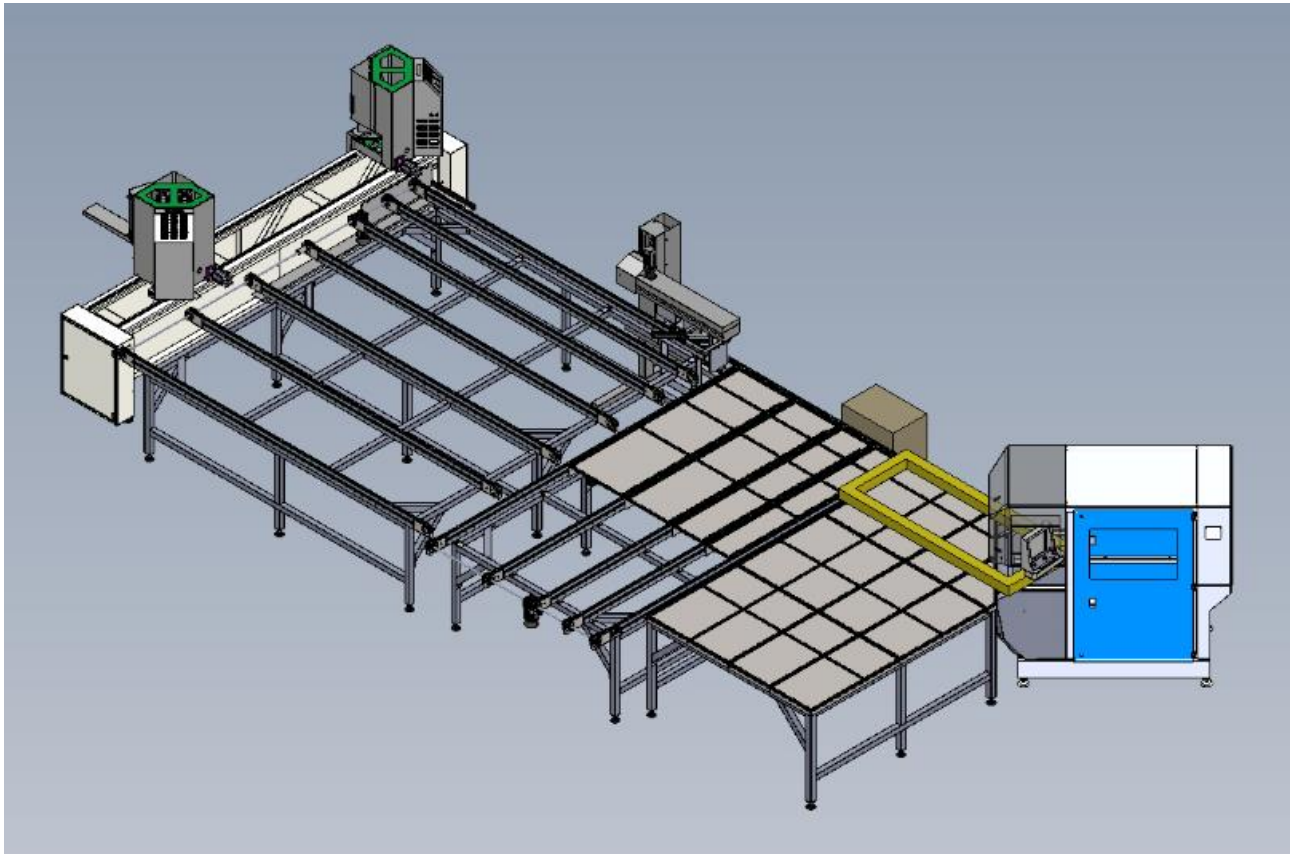

The corner welding and cleaning line for PVC profiles AUSTER consists of 5 main parts and depending on the welding machine installed in the line can handle frames of various sizes, in a fully automated mode:

1. Welding unit:

The GHIBLI S2 PVC welding machine is a two head welder with a maximum height 195 mm capability.

Quick fixture changing. Spew limiting knives adjustable between 0,2mm (for laminated wood-finish profiles) and 2 mm (for white profile). The temperature can be adjusted between 0-350° C with an electronic thermostat.

2. Cooling side:

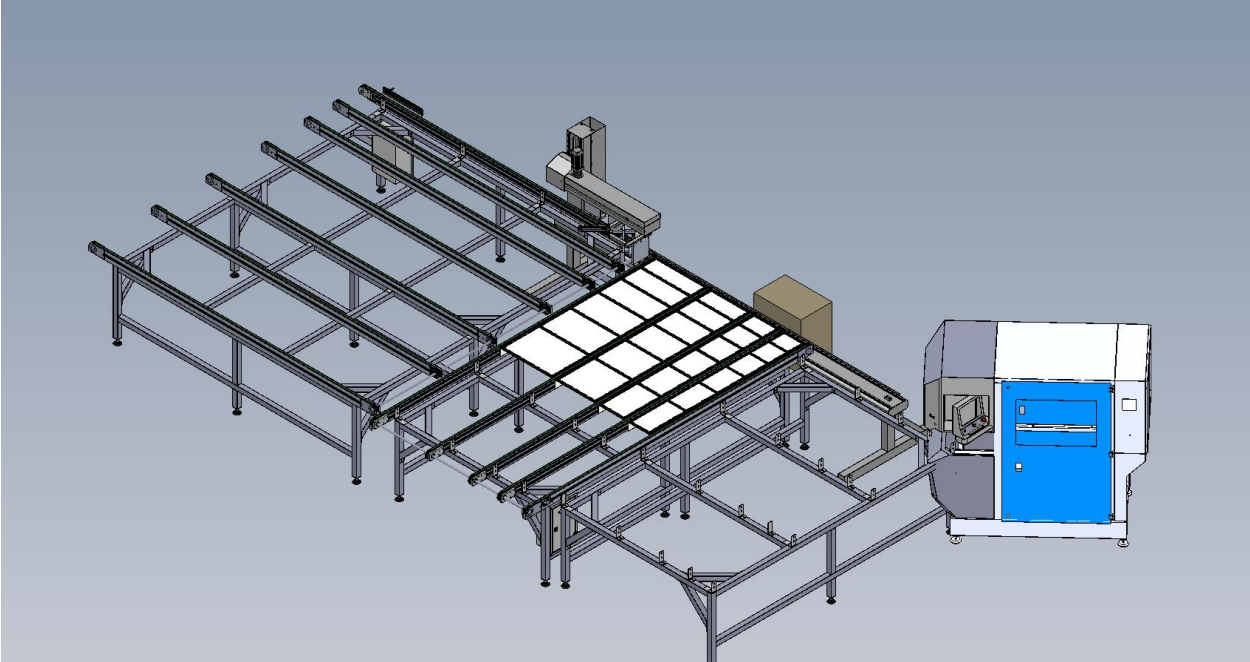

-cooling table for frames cooldown process and automatic movement.

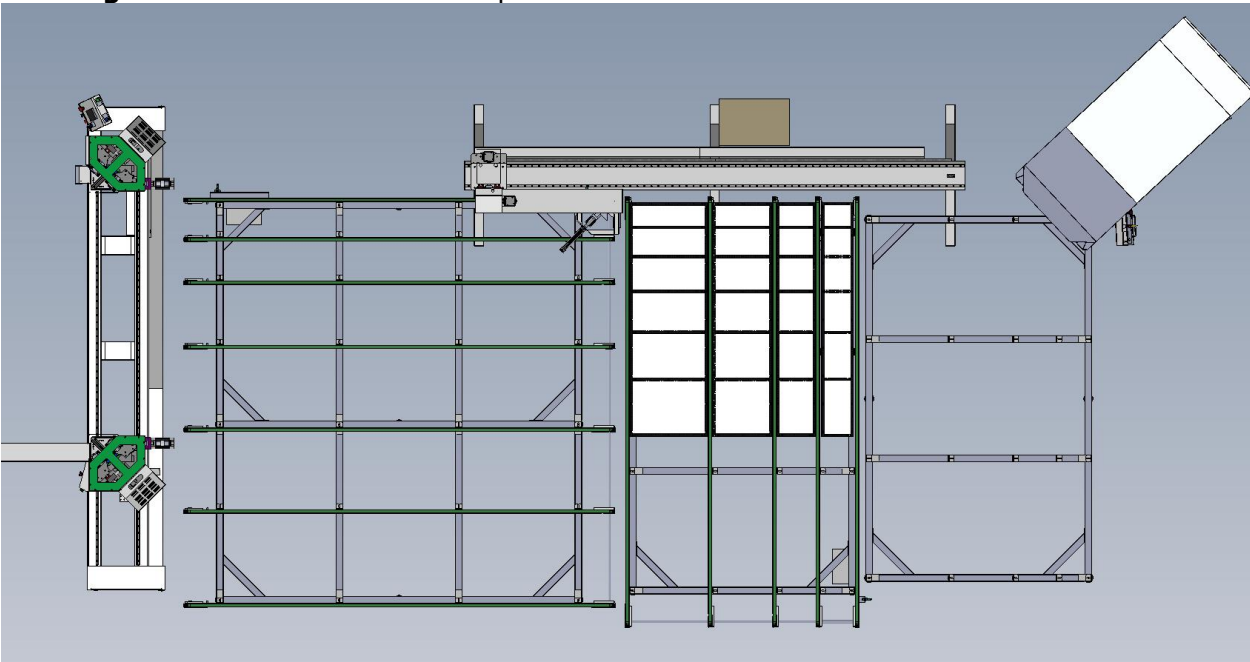

3. Turning side:

-turntable for automatic frames turning process until the CNC corner cleaner.

4. Corner Cleaner side:
-TORNADO CNC corner cleaner



TORNADO CNC Computer Numerically Controlled corner cleaning machine is designed for PVC frames and sashes with 2 interpolated axes and automatic cycling. It has a 250 mm diameter blade which allows, with different programs, the cleaning of outer corners on various profiles. The machine is also equipped with top and bottom knives for cleaning the welding beads on the faces of the profile plus top and bottom units with knives for cleaning the inside corners. Machining of the inner and outer corners and glazing faces can be completed with the top and bottom drilling/milling units. Each axis can be programmed independently via a CNC user friendly interface which allows to:

- Teach-mode programming
- DXF programming
- Loading of profile DXF drawing
- Tool path graphic visualization with different colors lines
- Profile height measuring to avoid errors

5. Outfeed side:
-Inline OUTFEED table for frames automatic unloading.

IMPORTANT!

To ensure the maximum safety of the operator the machine must be surrounded by safety guards that are not included in this offer and must be made by the customer.

